

## HOW YOU INSTALL

- 1 Screw the INVISAGRIP™ Starters onto the beam, hammer the first board onto the Starter pieces, then hammer the first row of INVISAGRIP™ Connectors onto the other side of the board.

Check that the board ends are flush. Set the second INVISAGRIP™ Connector row on the foundation beam.



- 3 Lay the preset INVISAGRIP™ Installation Tool on the board. Press the board down

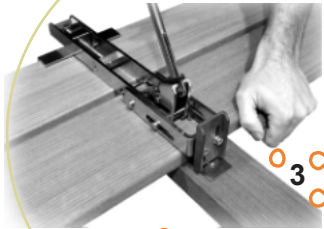

Pull the lever on the INVISAGRIP™ Installation Tool to create sufficient tension. The resulting joint space should be 1/4". If necessary, release and re-adjust the INVISAGRIP™ Installation Tool.

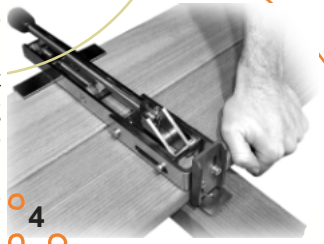

- 5 Screw down the INVISAGRIP™ Connector while the INVISAGRIP™ Installation Tool is still tight.



BUILT  
FOR YOU  
BUILT  
TO LAST

## CONTACT US

Get more information



ORDER  
**INVISAGRIP™**  
DECK FASTENING SYSTEM.



2606 Spring Cypress Road  
Spring, Texas 77388

Phone: +1 281 355 0707  
Fax: +1 281 355 5514  
E-mail: info@southlanddeck.com



Innovative,

Invisible,

and Easy!



**INVISAGRIP™**  
DECK FASTENING SYSTEM.

The INVISAGRIP™ Deck Fastening System is an **innovative** and **patented** development for easy, ingenious and **invisible** installation of decking.

Designed and engineered in Germany, with **6 million pieces already in use in Europe**, the system consists of **stainless steel** double angle INVISAGRIP™ Connectors along with the special INVISAGRIP™ Installation Tool.



TEL: +1 281 355 0707

www.southlanddeck.com



TEL: +1 281 355 0707

www.southlanddeck.com



**INVISAGRIP™**  
DECK FASTENING SYSTEM.

## WHAT IT IS



Decking  
without  
visible  
screws or  
nails

### Pure nature that's pleasing to the eye

The INVISAGRIP™ Deck Fastening System prevents any screws being seen on top of the decking - giving your deck a flawless appearance. The **double angle INVISAGRIP Connectors**, between the boards, are set with lever force using the INVISAGRIP™ Installation Tool. Ample space is created between the boards by design - eliminating the need for spacers.

### Wood preservation

The use of **stainless steel** is one of the secrets to the strength of the INVISAGRIP™ System. INVISAGRIP™ Connector's baseplate keeps **air space between the board** and the foundation beneath. The result is that the boards never touch the beams beneath, and any moisture dries quicker than traditional decking, **protecting and prolonging the life of the deck**. Also, without screws breaking the top surface of the deck, wood rot is greatly reduced.



**THE ART  
OF DECKING**

## HOW IT WORKS

**A complete system including the special installation tool**

**Assembly of the deck is simple** with the use of the INVISAGRIP™ Installation Tool. The INVISAGRIP™ Deck Fastening System allows you to **install your decking faster** than any conventional screw joint assembly currently on the market.

**Pre-drilling and countersinking are no longer required.** The special shape of the baseplates the system requires just one screw, and secures against warping. The **stainless steel** INVISAGRIP™ Connector's sharp spikes work **well with any traditional wood**, composite wood or hardwood such as **Bangkirai, Ipe and Acapu**.



**BUILT TO LAST**

## WHAT YOU NEED

You will need a few materials before you begin your deck assembly:

- Tape measure
- Hammer
- Electric screwdriver with extended bid number 2
- INVISAGRIP™ Installation Tool
- INVISAGRIP™ Connectors
- INVISAGRIP™ Starters \*
- Screws (included in the system)

\* Optional

Design your foundation framework by allowing no more than 20 in. between beams.

We recommend **for every 100 sqft. of decking** you will need **6 INVISAGRIP™ Starters and 84 INVISAGRIP™ Connectors** for your INVISAGRIP Deck Fastening System.



INVISAGRIP™ Starter



INVISAGRIP™ Connector



INVISAGRIP™  
Installation Tool



Screw



**INVISAGRIP™**  
DECK FASTENING SYSTEM.



**INVISAGRIP™**  
DECK FASTENING SYSTEM.

TEL: +1 281 355 0707

[www.southlanddeck.com](http://www.southlanddeck.com)